

AMERICAN PRO PRECISION BASS® (019361XXXX)

PARTS LAYOUT

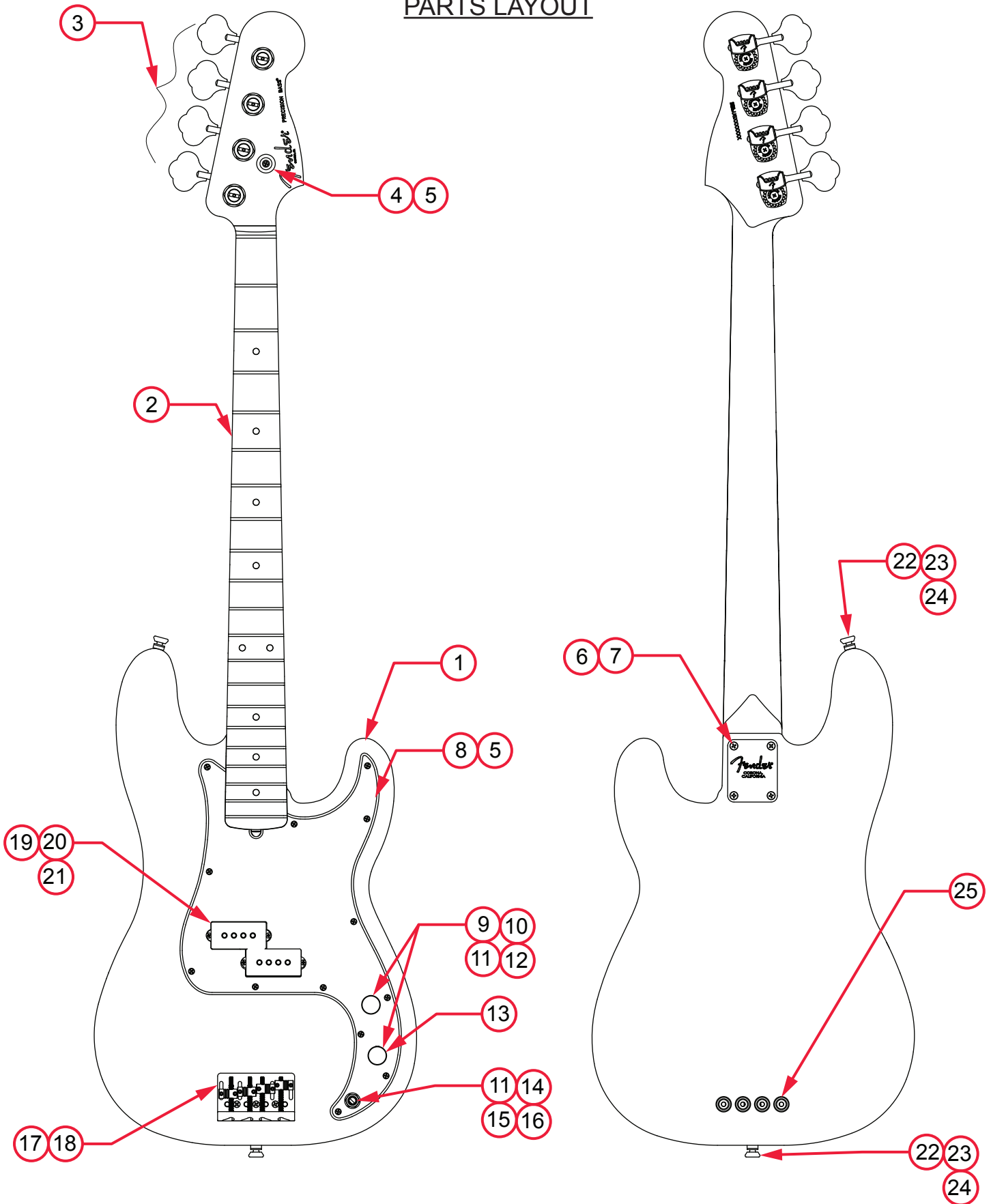

AMERICAN PRO PRECISION BASS® (019361XXXX)

PARTS LIST

REF#	DESCRIPTION	PART NUMBER
1	BODY AM STD P-BASS 3TS	0055217500
1	BODY AM STD P-BASS OWT	0056190505
1	BODY AM STD P-BASS BLK	0056190506
1	BODY AM STD P-BASS ATO	0056190576
2	NECK ASSY AM PRO P-BASS RW	7710439000
2	NECK ASSY AM PRO P-BASS MPL	7710440000
3	KEY BASS DLX NEW MOD TAPER LONG	7710693000
4	STRING GUIDE BASS CHROME W/SCREW	0994913000
5	SCREW SMAB 4 X 1/2 OHP NI	0015578049
6	NECK PLATE CORONA CA W/HARDWARE	0991446100
7	SCREW SMA 8 X 1-3/4 OHP NI	0015636049
8	PICKGUARD AM STD P-B ASS MG/BLK/MG	0053196000
9	KNOBS CONTROL ALUM CHROME W/SET SCREW	0095799049
10	CONTROL 250K 10% AUDIO METAL	0990831000
11	HEX NUT 3/8-32 X 3/32 TK NI	0016352049
12	WASHER LOCK INTL 3/8 X .687	0016436049
13	CAPACITOR CD .05µF 100V 20%	0015552049
14	JACK PHONE OPEN CIRCUIT	0021956049
15	WASHER FLAT 3/8 X .614 NI	0031153049
16	WASHER LOCKING INTL 3/8 X .500 X .020 NI	0022384049
17	BRIDGE ASSY HIGH MASS VINTAGE	0075124000
17A	BASE PLATE BASS HIGH MASS VINTAGE	0075125000
17B	BRIDGE BACKSTOP BASS HIGH MASS VINTAGE	0075126000
17C	BRIDGE SADDLE BASS HMV 1-2	0075127000
17D	BRIDGE SADDLE BASS HMV 3-4	0075135000
17E	SCREW 6-32 X 5/16 FHP ZI	0076154000
17F	SCREW CAP 6-32 X 1-1/2 HEX SKT BLX	0075394000
17G	SPRING TELE BRIDGE BLACK	0018872049
17H	SCREW SET 6-32 X 7/16 HEX SKT BLX NYLOK	0075354000
18	SCREW SMAB 5 X 1 OHP NI	0015610049
19	PICKUP ASSY AM PRO P-BASS	7710501000
20	PICKUP COVERS PRECISION BASS BLACK	0992037000
21	SCREW 4 X 1-1/4 WOOD RHP NI	0027035049

*= NOT PICTURED IN DIAGRAM



AMERICAN PRO PRECISION BASS® (019361XXXX)

WIRING ASSEMBLY

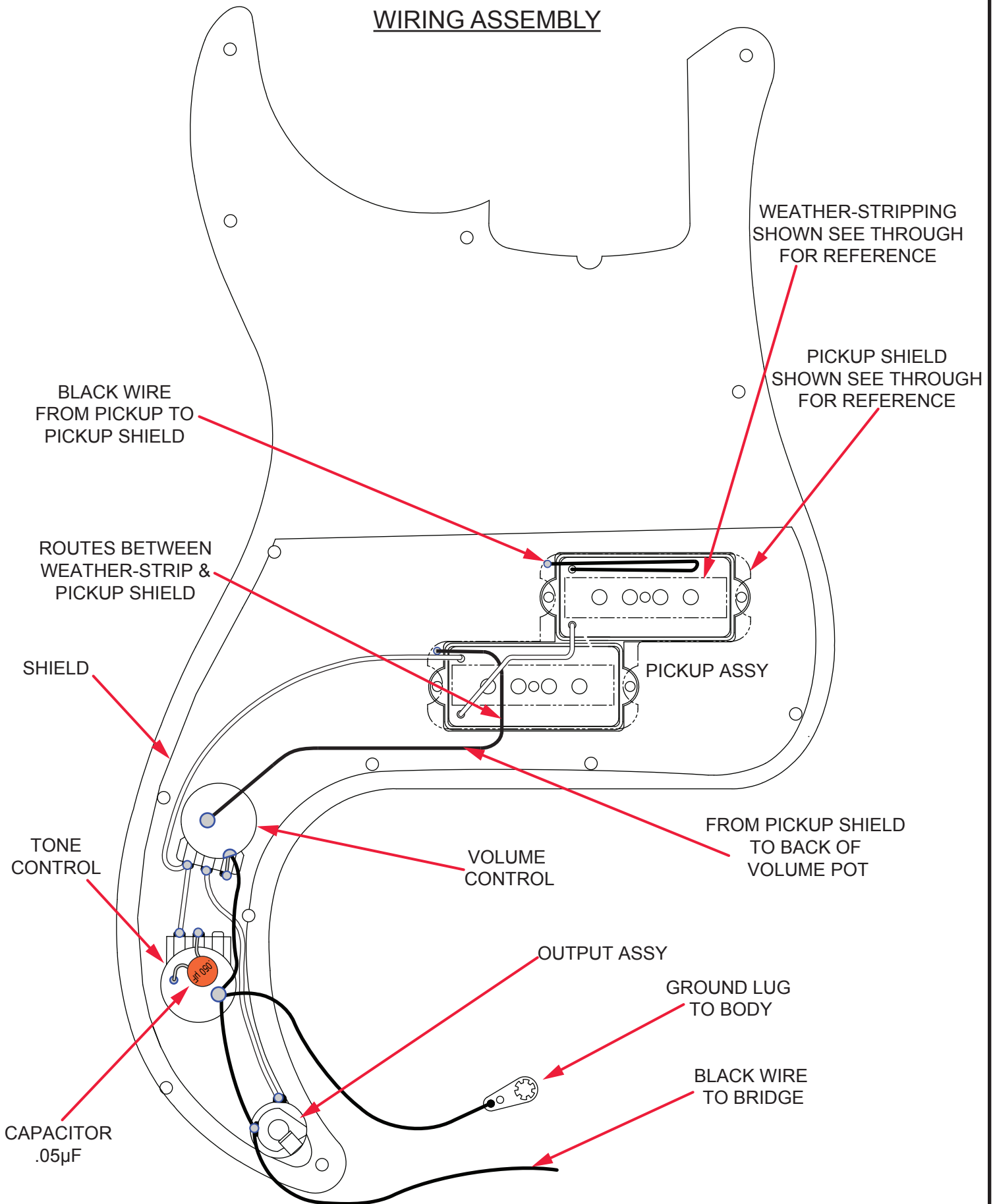

AMERICAN PRO PRECISION BASS® (019361XXXX)

SWITCH AND CONTROL FUNCTION

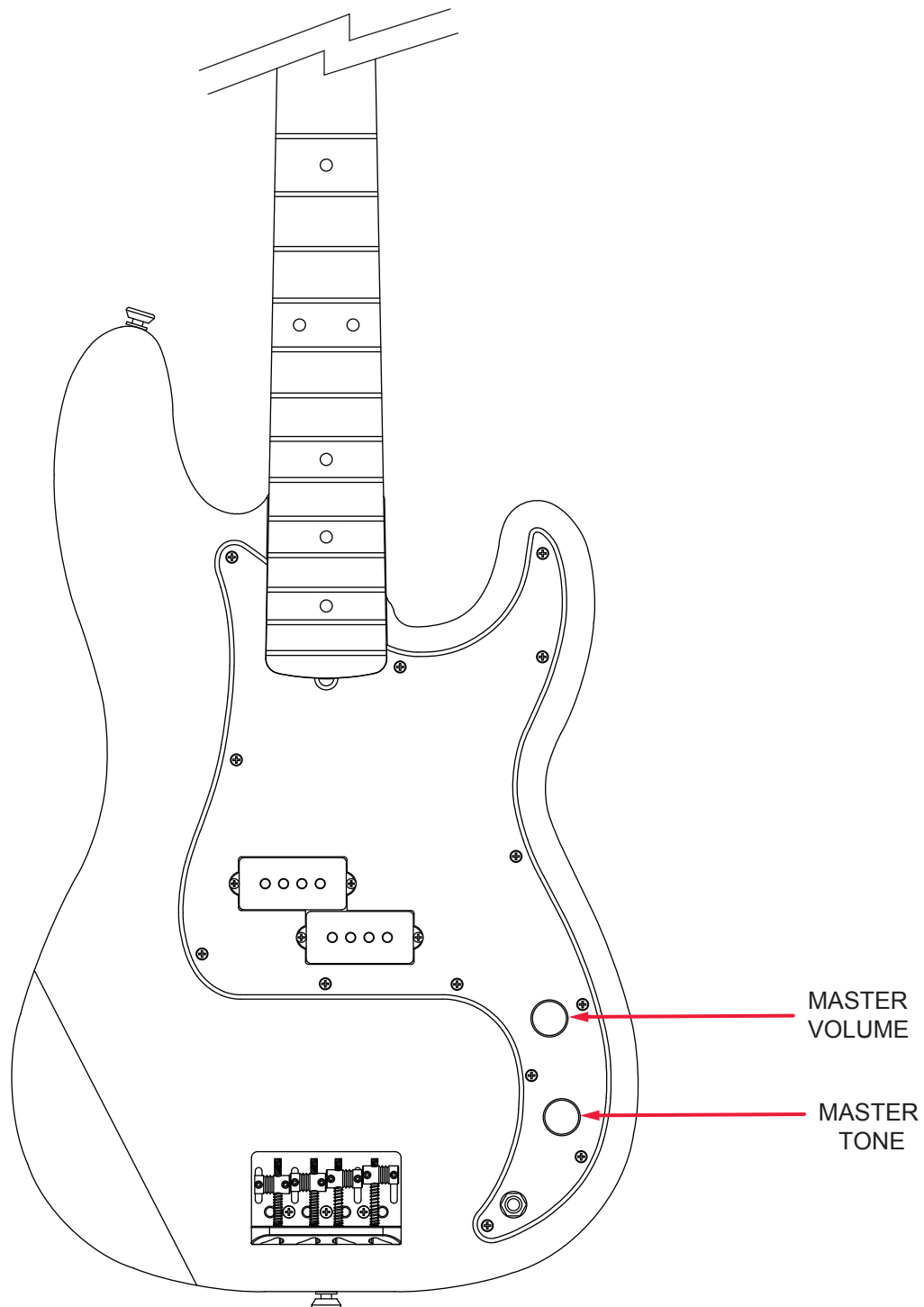

AMERICAN PRO PRECISION BASS® (019361XXXX)

ADDITIONAL SPECIFICATION DETAIL

FRET SIZE: JUMBO NARROW
(FRET DIMENSIONS ARE BEFORE INSTALLATION)

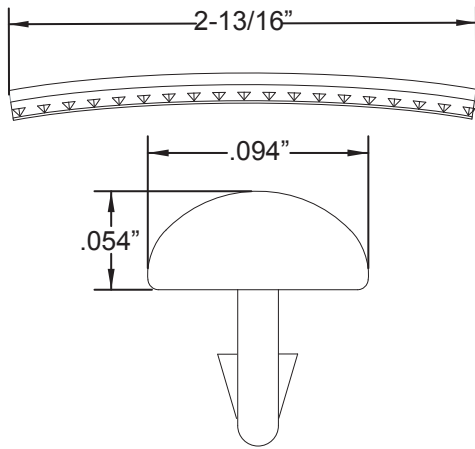

PLEASE NOTE: AS EACH NECK IS SANDED & FINISHED BY HAND, THICKNESS DIMENSIONS MAY VARY SLIGHTLY FROM THOSE SHOWN.

NECK PROFILE: VINTAGE "C"

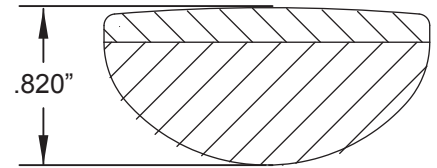

1ST FRET PROFILE

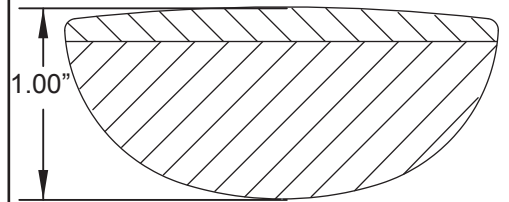

12TH FRET PROFILE

STAGGERED TUNING MACHINES SET: P/N 0097335049
OUTER SHAFT DIAMETER .533"

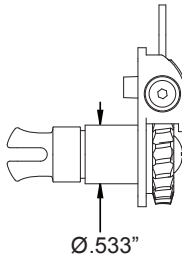

TUNING MACHINE THRU-HOLE
INNER DIAMETER .687"

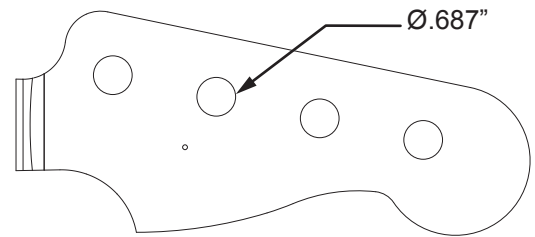

SADDLE HEIGHT ADJUSTMENT WRENCH:
1/16" HEX KEY P/N 0021109049
SADDLE HEIGHT ADJUSTMENT SCREWS: P/N 0075354000

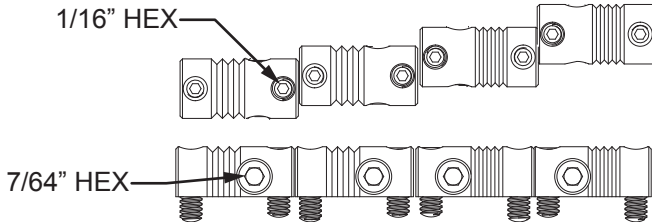

INTONATION ADJUSTMENT WRENCH:
7/64 HEX KEY P/N 0995504002

TRUSS ROD ADJUSTMENT NUT:
P/N 0048688049
TRUSS ROD ADJUSTMENT WRENCH:
3/16" HEX KEY P/N 7710885000

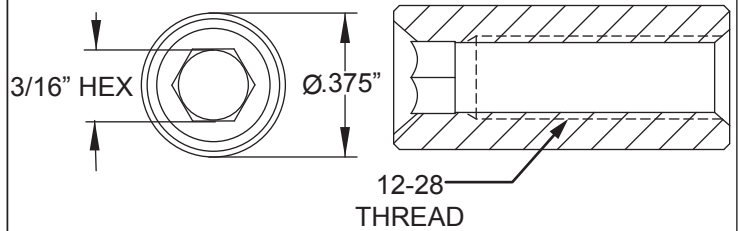

LOGO: AM PRO P-BASS DECAL
APPLIED UNDER THE FINISH



PICKUP SPECIFICATIONS

POSITION	MAGNETS	DC RESISTANCE	POLARITY
NECK	ALNICO 2 BEVELED	5.5 - 6.1KΩ	NORTH
BRIDGE	ALNICO 5 BEVELED	5.6 - 6.2KΩ	SOUTH